

“GEA” Bench

Sheet code: PAAR007

Drawing code:

Revision: 21/01/2019

Designer:
Bellitalia Design Department



Product: Linear modular bench model “GEA”.

Dimensions: length: 630 mm;
width: 664 mm;
height: 880 mm;
total weight: about 290 kg.

Material: The bench can be manufactured using reconstituted natural marble stones or white granite conglomerate. The lateral holes are closed with stainless steel thread bars, washers and hexagonal cup head bolts.

Reinforcing: The bench is reinforced.

Finishing: All visible concrete surfaces are completely sandblasted, and then covered with a transparent anti-decay coating, or, upon request, with anti-graffiti products.

Handling: Use appropriate equipment when handling.

Installation: Simply place on the flooring.

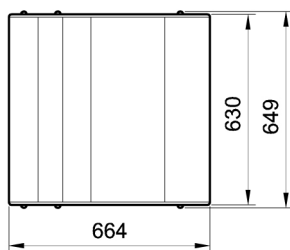
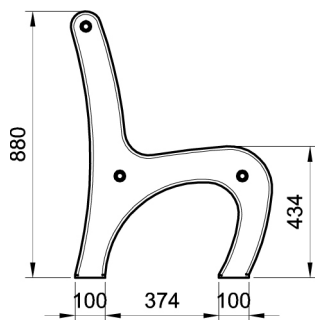

“GEA” Bench with armrest

Sheet code: PAAR008

Drawing code:

Revision:

02_01/10/2015

Designer:
Bellitalia Design Department

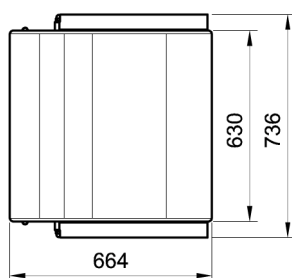
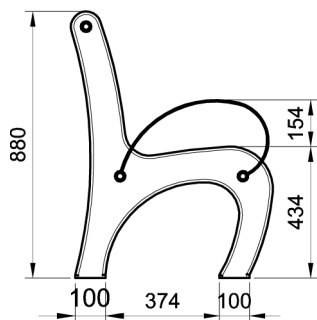

Product: Linear modular bench model “GEA”, with armrest on both sides.

Dimensions: length: 736 mm;
width: 664 mm;
height: 880 mm;
total weight: about 293 kg.

Material: The bench can be manufactured using reconstituted natural marble stones or white granite conglomerate. Steel or stainless steel armrests, fastened by thread bars, washers and hexagonal cup head bolts, which close the backrest holes too.

Reinforcing: The bench is reinforced.

Finishing: All visible concrete surfaces are completely sandblasted, and then covered with a transparent anti-decay coating, or, upon request, with nanotechnology and/or anti-graffiti products. All metal parts can be treated by a hot dip galvanisation and painted with RAL7021 if in steel, or can undergo a satin finish treatment if in stainless steel. All edges are rounded or made blunt.

Handling: Use appropriate equipment when handling.

Installation: Simply place on the flooring.

Solid "GEA" Bench with wooden slats cladding

Sheet code: PAAR035

Drawing code:

Revision:

02_01/10/2015

Designer:

Bellitalia Design Department



Product:

Linear modular bench model solid "GEA", with wooden slats cladding.

Dimensions:

length: 630 mm;
width: 718 mm;
height: 908 mm;
total weight: about 340 kg.

Material:

The bench can be manufactured using reconstituted natural marble stones or white granite conglomerate. The wooden cladding is composed by 25 slats having a section of 43x21 mm and offered with four different types of essence: movingui, pine, pine thermowood®, okumè or, upon request, accoya® (please see respective material sheet). Slats are fastened to the seat through screws and two stainless steel plates 40x5, bended to ease the water discharge under the slats. The lateral holes are closed with stainless steel thread bars, washers and hexagonal cup head bolts.

Reinforcing:

The bench is reinforced.

Finishing:

All visible concrete surfaces are completely sandblasted, and then covered with a transparent anti-decay coating, or, upon request, with nanotechnology and/or anti-graffiti products. All wooden elements in movingui, pine and okumè can be impregnated and painted with a protective varnish, or treated, upon request, with an ultra-resistant coating, like "Sikkens" or, for pine wood only, with the thermowood® treatment. Accoya® wood and thermowood® do not need any special finishing (please see respective material sheets). All edges are rounded or made blunt.

Handling:

Use appropriate equipment when handling.

Installation:

Simply place on the flooring.

